

LPS Series, D5 Custom Datasheet

This drawing specifies a non-standard type

All other specifications are according to the LPS standard Datasheet



VITROHM



ORDERING CODE-Example

New SAP Part Nr.:

LPS	130	J	V	-	CM-	R01	D5
Serie	Power rating	Tol.	Pack-Code	TCR	Forming type	R-Value	Special
	130 = 1,3W	H = ±3% J = ±5%	V = Vacuum	- Base on spec.	CM- = Custom made		

Historical VTM Part Nr.:

LPS359 – 115	5	B	OR01
Type	Tol.	Pack-Code	R Value

ELECTRICAL SPECIFICATIONS

Type			LPS130...D5
Historical Part Number			LPS359-115
Nominal Power Rating P_{70}		[W]	1,3
Resistance Range		[Ω]	R01
Tolerances		±[%]	H = 3% ; J = 5%
Temperature Coefficient		±[10 ⁻⁶ K ⁻¹]	-80 ...+40 (CuNi44)
Marking		[m Ω]	10

DIMENSIONS [mm]

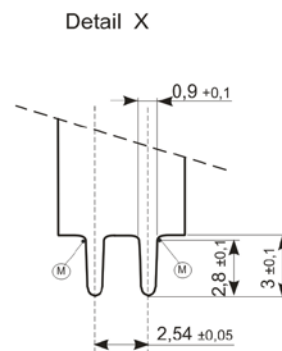
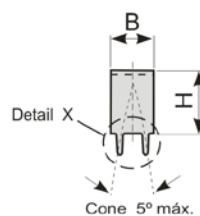
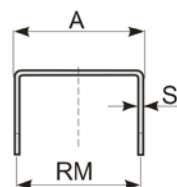

Ⓜ Measuring point

Type	Historical P/N:	RM ±0,35	A ±0,35	H max.	B ±0,15	S ±0,1	Recommended diameter [Ø]
LPS130...D5	LPS359-115	15,0	15,3	7,0	4,0	0,3	1,1

This drawing shows the difference to the standard type
Preform according above specs

PACKAGING

Standard packaging:

Type	Historical P/N:	Pack Code	Pieces	Forming Type	Special
LPS130...D5	LPS359-115	V = Vacuum	2000	CM-	D5